



**BONNET GRANDE CUISINE**

**Registered office:**

Rue des Frères Lumière - Z.I Mitry Compans

F-77292 MITRY MORY Cedex

## **OPTIMUM, Electric cooking top, 2 ELECTRIC RINGS**



FlushTop

### **2 ELECTRIC RINGS B107PE4DE**

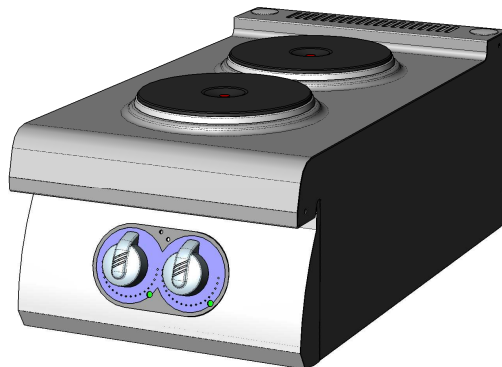

### **OPTIMUM ASSETS**

**FlushTop** : Module can be butt jointed.

### **GENERAL**

- \* Upper structure totally stainless (top 2mm thick and inset side faces in 1.5mm laser welded)
- \* All stainless steel construction designed to avoid any infiltration.
- \* Unfailing sturdy equipment for direct wall fixation.
- \* Controls grouped together and recessed protecting them for impact and spillages.

### **ELECTRIC RINGS**

- \* One piece pressed top fitted with 2 cast iron rapid heat rings 220mm diameter.
- \* Each ring is controlled by a 6 position switch and has an indicator light.
- \* High limit thermostat built into each ring.

### **ACCESSORIES**

- \* See technical data : General features.

### **STANDARDS : Compliance with standards**

**EN 60335-2-36**: European standards relating to the safety of electric appliances.  
(French standards: Classification index C 73-836).

**IP 25 and IK 9**: Protection indexes.

**XP U 60-010**: Hygiene.





**BONNET GRANDE CUISINE**

**Registered office:**

Rue des Frères Lumière - Z.I Mitry Compans

F-77292 MITRY MORY Cedex

**B107PE4DE**

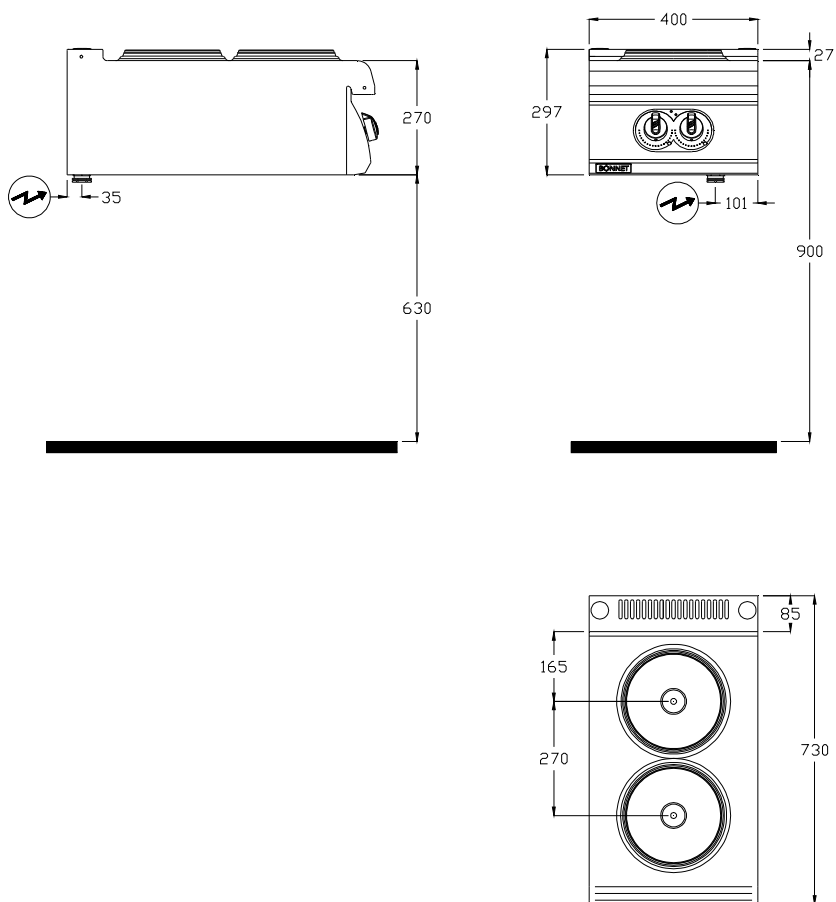

**ELECTRICAL connection**  
Electric inlet at 615mm from the floor  
(Flexible cable 1.5 m in length)

**DIMENSIONS (mm)**

Width	400
Depth x Height	730 x 297
Diameter of plate	220

**PACKAGING (mm)**

Width	540
Depth x Height	1060 x 700

**WEIGHT (KG)**

30

**COMPOSITION OF TOP**

Round plate 2.6 kW	2
--------------------	---

**ELECTRICITY** (Triphasé 230V+E or 400V+N+E)

Power (kW)	230V 3a.c.	5.2
	400V 3Na.c.	5.2
Max. Intensity (A)	230V 3a.c.	19.6
	400V 3Na.c.	11.3