

## Low Temp GN 1/1 - Depth 700

Remote 2 doors model

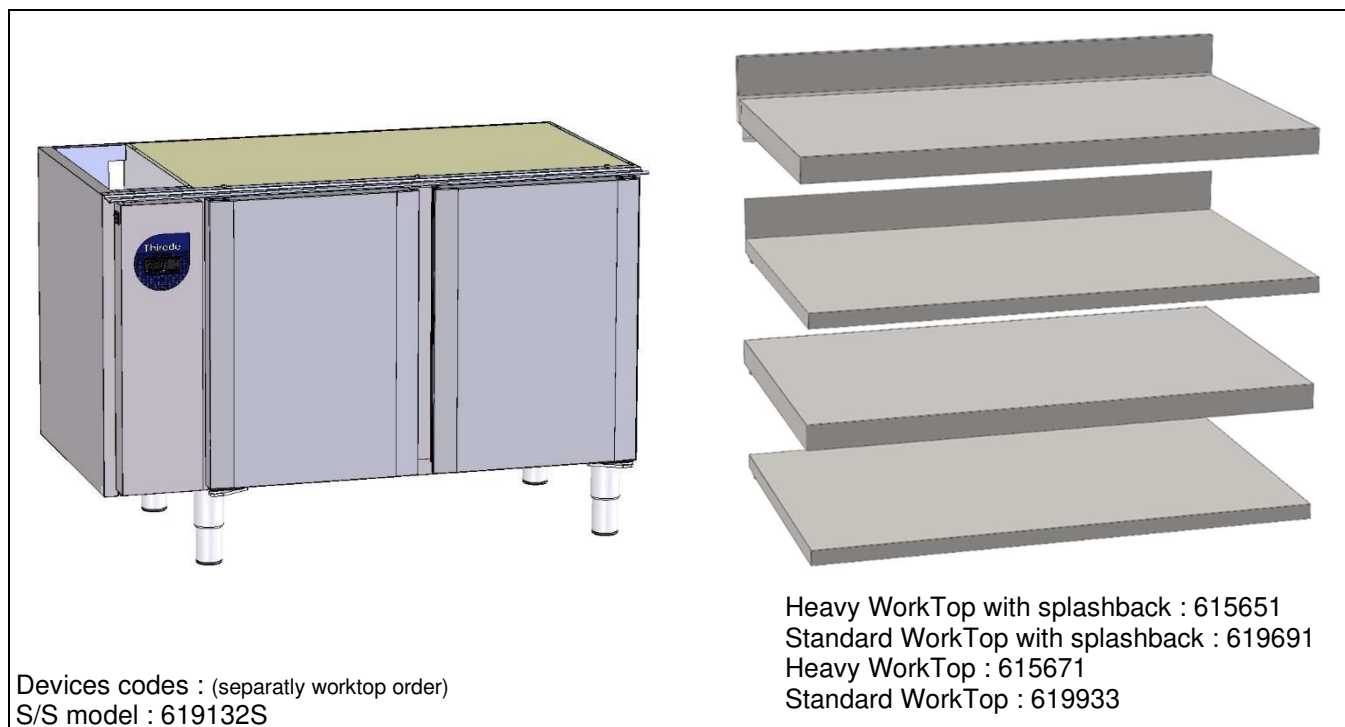

- \* The **low temp** (-18° à -21°C) refrigerated counter is designed to stock foodstuffs for an ambient temperature of 43°C. It works with R290 fluid.
- \* Capacity of **266 liters**. Delivered with 2 trayslide and 1 S/S shelf GN1/1 per door. The counter can fitted 8 shelves or bac (55mm), step 60mm.
- \* Regulation by electronic display, on/off switch, power indicator light and high and low temperature alarm, visual and audible.
- \* Automatic desfrost and vaporized defrost water by heater.
- \* 304 S/S Inner shell.
- \* 304 S/S external 3 faces. Anti corrosion galvanized unit support, external back and bottom.
- \* Fungicidal magnetic door gasket. Spring loaded hinges for automatic door closing with 90° dwell.
- \* S/S legs with adjustment for leveling (height 195 +25mm/-45mm).
- \* Cataphoresis treated evaporator.
- \* Bi-directional ventilation for temperature uniformity in the enclosure (Delta T °: <2 ° K).

### OPTIONS et ACCESSORIES

- Dessus mural renforcé
- Dessus mural standard
- Dessus central renforcé
- Dessus central standard
- Serrures/porte
- USB (fourni avec logiciel de traitement)
- Fond rayonné (Inox 304 ou aluminium)
- 2 tiroirs 1/2
- 3 tiroirs 1/3
- Rappel automatique de fermeture avec amortisseur pour bloc tiroirs 1/2
- Rappel automatique de fermeture avec amortisseur pour bloc tiroirs 1/3

- Roulettes
- Habillage arrière inox

#### Accessoires :

- Clayette inox GN 1/1
- Glissières de clayette supplémentaire

**Other options and accessories (on request):** Base for masonry plinth, technical compartment reversal, composition strip kit for drawer bin or castor kit.

# COUNTER

Low temp model 2 doors remote

## Technical characteristics

Dimensions (mm)		Nominal height (+25/-45)			Width	Dep.
		Heavy WorkTop	Standard WorkTop	Without WorkTop		
	External	900	875	845	1200	700
	Inner	545			380/door	565
Weigh (Kg)						
	Gross	110				
Electricity						
	Voltage	230V 1~				
	Frequency	50 Hz				
	Protection	aM 2 A				
	Maximum power	405 W				
Refrigerated system						
	Refrigerating power	463 W à -30/+55°C				
	Compressor type	/				
	Evaporator type	Ventilated				
	Fluid	R452A				
	Acoustic pressure	/				
	Heat release	/				
	Gas expansion	Expansion valve				
	Condensation	/				
Capacities						
	Gross volume (L)	266				
	Shelves	GN 1/1 325x530 (1/door)				
	Max. level number	8 per door, step 60mm				
Temperatures						
	Max. ambient	+43°C				
	Climate class	/				
	Temperature rang	-18/-21°C				
	Energetic class	/				
Construction						
	Type	Monoshell				
	External	3 faces 304 S/S , external galva. sheet back and bottom				
	Inner	304 S/S				
	Insulation	Polyurethane th.60mm				
Standard						
		Safety : EN 60 335-1 Hygiene : NF EN 1672-2				

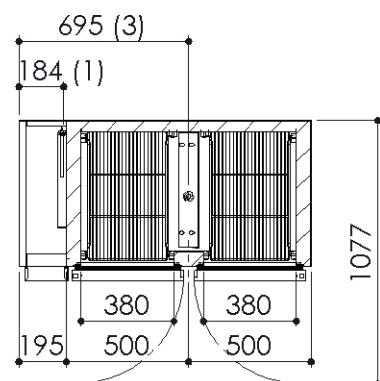
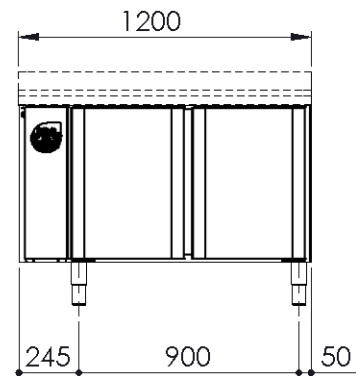

Heavy WorkTop

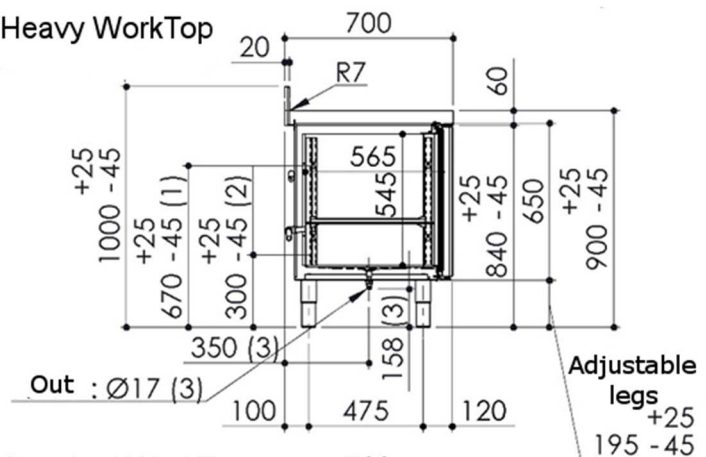

Standard WorkTop

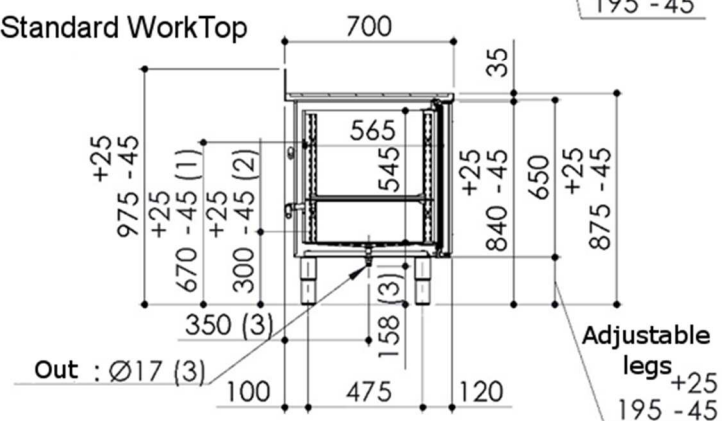

- (1) : Electric connexion
- (2) : Defrost water out
- (3) : Drain option

This document is not contractual n° 6TE657452-1120 - THIRODE reserves the right to improve or modify its products without notice

**Thirote**

Rue des Frères Lumière - Z.I. Mity Compans - 77292 MITRY MORY cedex  
Tél.01 64 67 61 00 - Fax.01.64.67.61.01