

## High Temp GN 1/1 - Depth 700

Integral 3 doors model

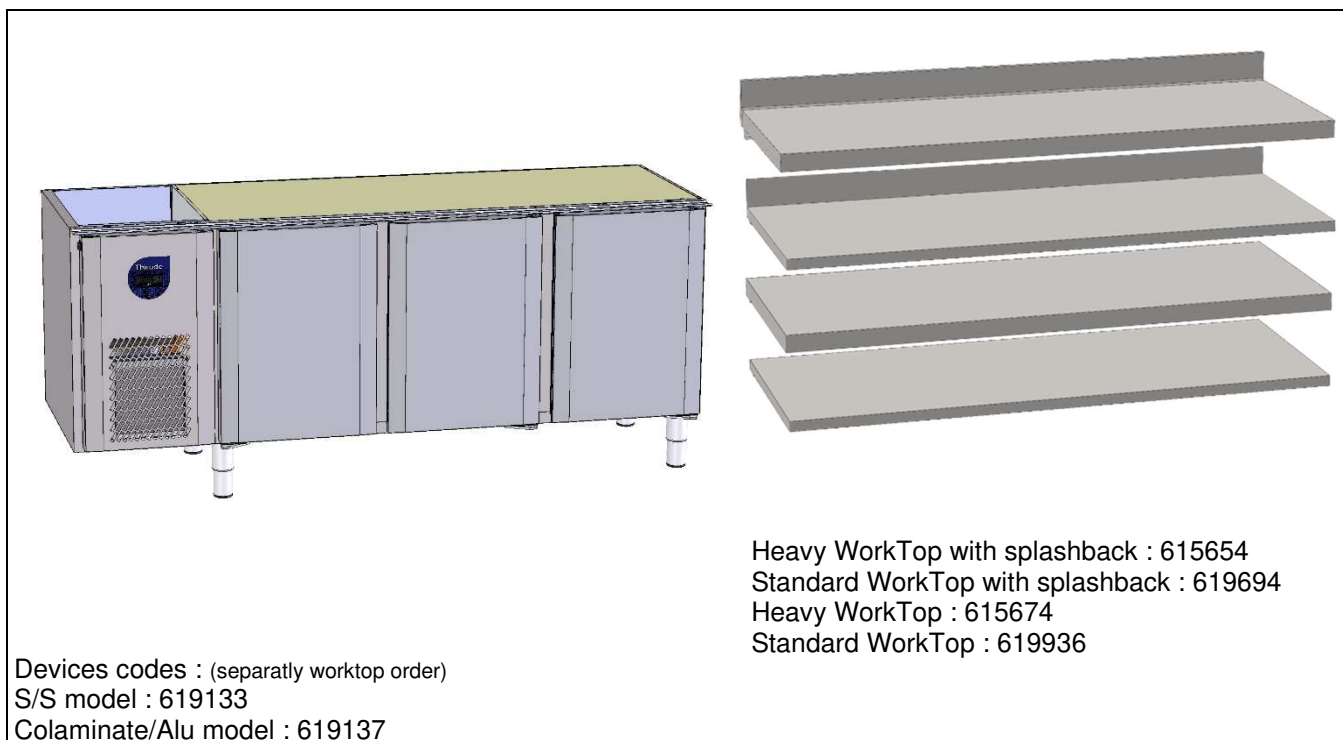

- \* The **high temp** (0° à +12°C) refrigerated counter is designed to stock foodstuffs for an ambient temperature of 43°C. It works with R290 fluid.
- \* Capacity of **417 liters**. Delivered with 2 trayslide and 1 S/S shelf GN1/1 per door. The counter can fitted 8 shelves or bac (55mm), step 60mm.
- \* Regulation by electronic display, on/off switch, power indicator light and high and low temperature alarm, visual and audible.
- \* Automatic desfrost and vaporized defrost water by hot gas.
- \* 304 S/S or aluminium Inner shell.
- \* 304 S/S or colaminate external 3 faces. Anti corrosion galvanized unit support, external back and bottom.
- \* Fungicidal magnetic door gasket. Spring loaded hinges for automatic door closing with 90° dwell.
- \* S/S legs with adjustment for leveling (height 195 +25mm/-45mm).
- \* Cataphoresis treated evaporator.
- \* Bi-directional ventilation for temperature uniformity in the enclosure (Delta T °: <2 ° K).

### OPTIONS et ACCESSORIES

- |  |                  |
|--|------------------|
| - Heavy WorkTop with splashback                              | - Castors        |
| - Standard WorkTop with splashback                           | - S/S back cover |
| - Heavy WorkTop  |                  |
| - Standard WorkTop   |                  |
| - Sink (370 × 340 × 150)                                     |                  |
| - Lock per door  |                  |
| - USB recorder   |                  |
| - Radius inner bottom (304 S/S or aluminium)                 |                  |
| - 2 drawers 1/2  |                  |
| - 3 drawers 1/3  |                  |
| - Automatic closing reminder with damper for drawer unit 1/2 |                  |
| - Automatic closing reminder with damper for drawer unit 1/3 |                  |
- Accessoires :
- GN 1/1 S/S shelf
  - 2 × tray slide for 1 shelf

**Other options and accessories (on request):** Electric re-evaporation of defrost water, base for masonry plinth, technical compartment reversal, composition strip kit for drawer bin or castor kit.

# COUNTER

## High temp model 3 doors integral

### Technical characteristics

Dimensions (mm)		Nominal height (+25/-45)			Width	Dep.
		Heavy WorkTop	Standard WorkTop	Without WorkTop		
	External	900	875	845	1900	700
	Inner	545			380/door	565
Weigh (Kg)						
	Gross	210				
Electricity						
	Voltage	230V 1~				
	Frequency	50 Hz				
	Protection	aM 2 A				
	Maximum power	220 W				
Refrigerated system						
	Refrigerating power	425 W à -10/+45°C				
	Compressor type	Hermetic				
	Evaporator type	Ventilated				
	Fluid	R290				
	Acoustic pressure	31 dBA				
	Heat release	4320W/24H				
	Gas expansion	Capillary				
	Condensation	Air				
Capacities						
	Gross volume (L)	417				
	Shelves	GN 1/1 325x530 (1/door)				
	Max. level number	8 per door, step 60mm				
Temperatures						
	Max. ambient	+43°C				
	Climate class	5 (40°C / 40% Hr)				
	Temperature rang	-2/+12°C				
	Energetic class	C / 2.90 KW/24h				
Construction						
	Type	Monoshell				
	External	3 faces 304 S/S or colam., external galva. sheet back and bottom				
	Inner	304 S/S or aluminium				
	Insulation	Polyurethane th.60mm				
Standard						
		Safety : EN 60 335-1 Hygiene : NF EN 1672-2				

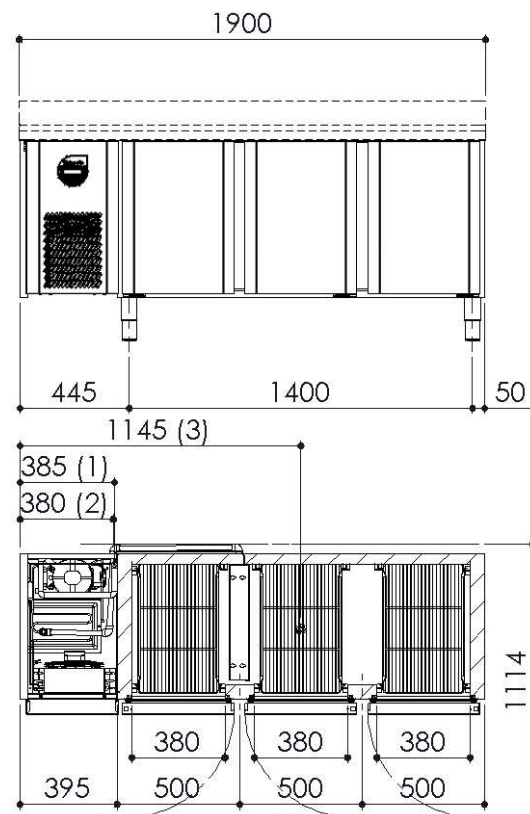

Heavy WorkTop

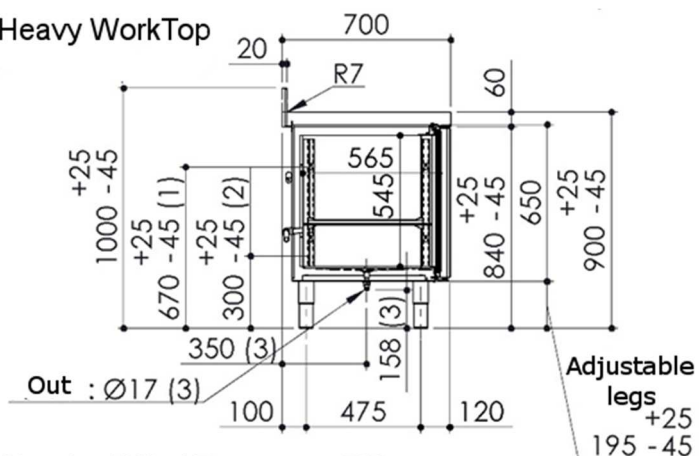

Standard WorkTop

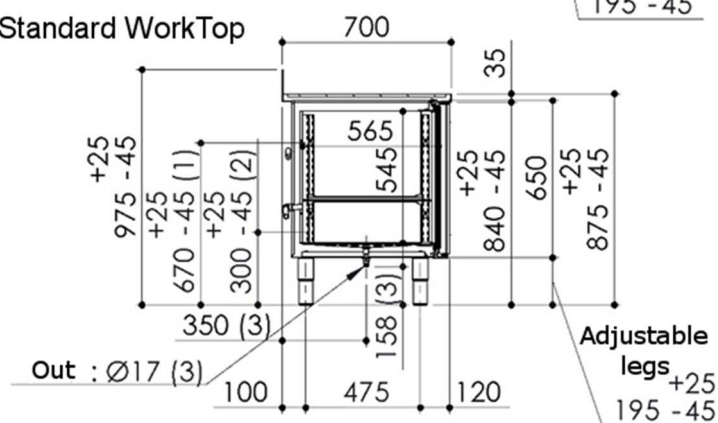

- (1) : Electric connexion
- (2) : Defrost water out
- (3) : Drain option

This document is not contractual n° 6TE657453-1120 - THIRODE reserves the right to improve or modify its products without notice

**Thirote**

Rue des Frères Lumière - Z.I. Mity Compans - 77292 MITRY MORY cedex  
Tél.01 64 67 61 00 - Fax.01.64.67.61.01